

THREE OUTPUT SIGNALS 4-20 mA CURRENT, 0-5/ 10 VDC VOLTAGE OUTPUTS
PRESSURE TRANSDUCERS & TRANSMITTERS WITH 5 1/2 DIGITS BACKLIT LCD DISPLAY



FTB PT-75 Pressure Transducers were designed to provide a wide variety of output signals suitable for all industrial applications, which need either CURRENT 4-20 mA or VOLTAGE (0-5 VDC or 0-10 VDC) outputs. "One Size Fits All.", the output signals that PT-75 offers cover the entire industrial applications from hydraulic and pneumatic systems to refrigeration equipment with high accuracy of 1% Full Scale.

No need to worry about the Temperature Compensations that most pressure transducers worry the most on market, the PT-75 is a more reliable Pressure Transducer derived from other FTB Digital-Family Products, Digital Pressure Gauges (DPG-75) and Digital Pressure Switches (DPS-75), with FTB-developed and patented technology.

Advanced manufacturing techniques combined with technologically advanced standard features allow FTB to offer a level of performance with no extra cost increased for an additional digital pressure gauge with 5 1/2 digits backlit LCD display previously found only on a combination of transducers with digital pressure gauges.

ORDERING INFORMATION

When ordering, please follow the example order code below.

Example Order Code **DPG - 75 - A120 - (200) - N - L - N - B - 1 - 1**
or 15 DPS/PT DPS Only

Model _____
DPG = Digital Pressure Gauge
DPS = Digital Pressure Switch
PT= Pressure Transducer / Transmitter (using D24 power only)

Power _____
D24 = 5-24 Volts DC Input (2-wire wiring/ 1.5 meters)
A120 = 100-120 Volts AC Adapter (included) + D24
A240 = 220-240 Volts AC Adapter (included) + D24

Pressure Ranges (PSI) / KG
V = Vacuum 0-280 = (280)/20 0-2800 = (2.8K)/200 0-15000 = (15K)/1000
0-15 = (15)/1 0-350 = (350)/25 0-3500 = (3.5K)/250
0-30 = (30)/2 0-500 = (500)/35 0-4200 = (4.2K)/300
0-40 = (40)/3 0-570 = (570)/40 0-5000 = (5.0K)/350
0-60 = (60)/4 0-700 = (700)/50 0-5700 = (5.7K)/400
0-100 = (100)/7 0-1000 = (1.0K)/70 0-7000 = (7.0K)/500
0-140 = (140)/10 0-1400 = (1.4K)/100 0-8500 = (8.5K)/600
0-200 = (200)/15 0-2100 = (2.1K)/150 0-10000 = (10K)/700

Type of Connection _____
N = NPT
P = PT/BSP(T)
B = BSP/PF

Type of Mounting _____
L = Lower Mount
B = Lower Back Mount

Flange _____
N = Without Front Flange
F = With Front Flange

Default Engineering Unit _____
B = bar P = psi K = kg/cm²
M = MPa A = kPa 1 = "Hg
2 = cmHg 3 = mmHg

Output Signal (PT Only) _____
1 = 4-20 mA 2 = 0-5 VDC 3 = 0-10 VDC

High Setting Points/Contacts (DPS Only) _____
0 = None 1 = 1 High 2 = 2 Highs 3 = 3 Highs 4 = 4 Highs

Low Setting Points/Contacts (DPS Only) _____
0 = None 1 = 1 Low 2 = 2 Lows 3 = 3 Lows 4 = 4 Lows

Size of Connection _____
1/4" PT (standard)

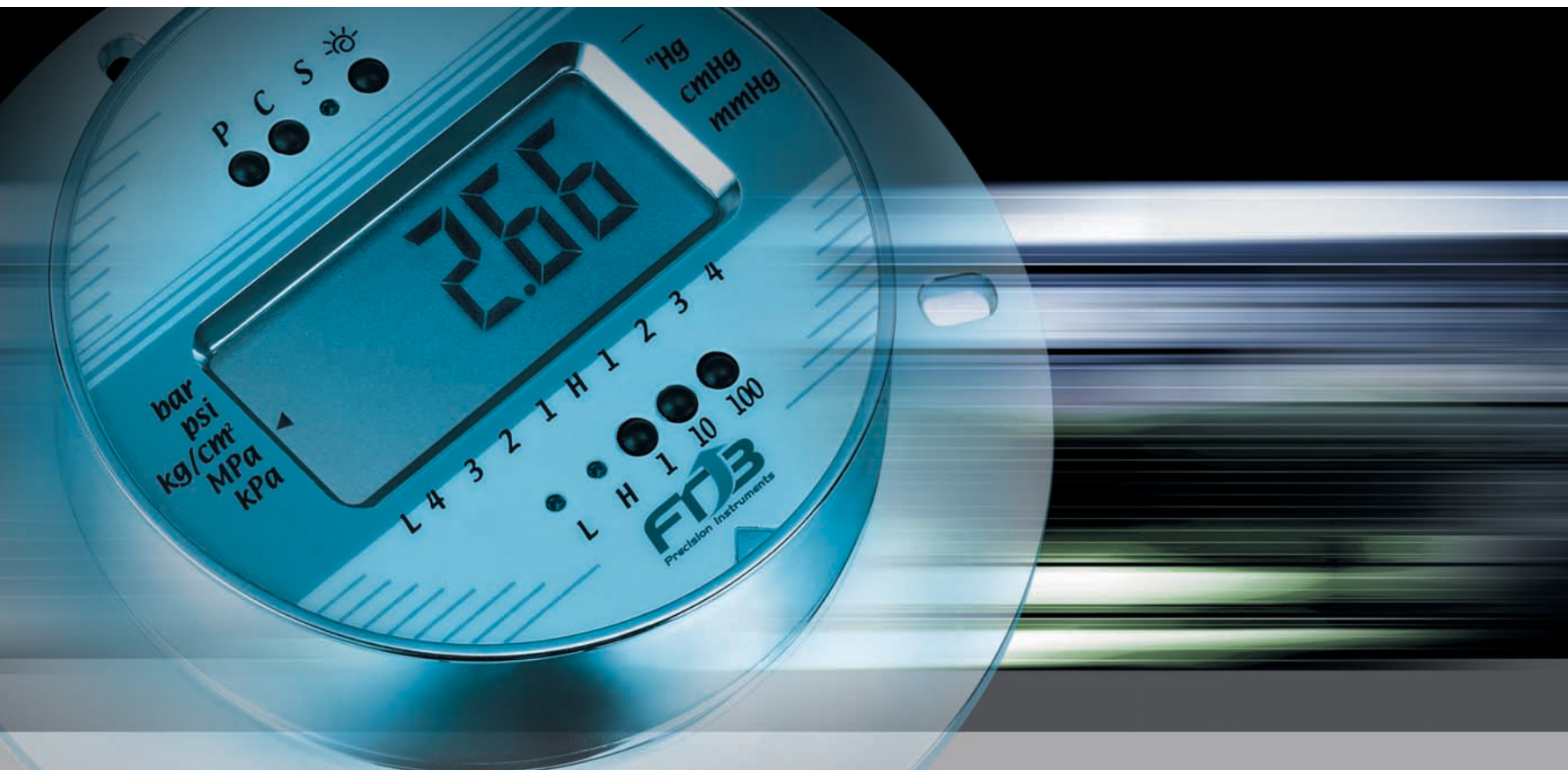

Digital Pressure Gauge / Switch / Transducer Transmitter

Patents Registered Worldwide

Digital Pressure

Gauge / Switch / Transmitter Transducer

The DPG-75 Digital Pressure Gauge with 1% full scale accuracy uses FTB-developed and patented technology as your cutting edge, cost-saving provider for digital solutions. The FTB-developed technology delivers stable and long-lasting performance. 5 1/2 digit blue backlit LCD makes DPG-75 the largest in window size Digital Pressure Gauge found available on market. The DPG-75 was built for the applications which the cost for digital solutions is highly concerned.

The DPG-75 is rugged and features High Pressure Capture with pressure ranges ranging from vacuum (bar, "Hg, cmHg, mmHg) to 15,000 PSIG (displayed also in bar, kg/cm², MPa, and kPa). An AC power adapter of 100-240 Volts with 50-60 Hz is included for easy installation; also, an DC power of 5-24 Volts is available as an option for DC power input as well. Typical applications include test and measurement in the process industries, hydraulic and pneumatic systems, industrial gases, industrial machinery and machine tools, injection molding machines, stamping and forming presses, and pumps and compressors.

Besides the functions that the DPG-75 has to offer, the DPS-75 Digital Pressure Switch does deliver an additional pressure switch function to the applications which the control of set pressures is needed. Equipped with 8 Pressure Setting Points, the DPS-75 is the most economical digital pressure switch available on market ever.

FEATURES

- $\pm 1\%$ Full Scale Accuracy.
- Ranges from Vacuum to 15,000 PSIG (1,000 kg/cm²).
- Positive Pressures (bar, psi, kg/cm², MPa, and kPa), Negative Pressures ("Hg, cmHg, mmHg, bar).
- 5 1/2 Digits Blue Backlit LCD.
- High Pressure Capture.
- CE Compliant.
- Rugged ABS Plastic Housing with black lacquered.
- Customer Recalibration.
- Zero Offset/Tare.

ACCESSORIES

Pressure Adapters
TO 7/16"-20 SAE Oring Connection.
TO 3/8", 1/2" Connection Adapters.
(Call factory for other fittings.)

SPECIFICATIONS

	DPG-75	DPS-75	PT-75
Accuracy	± 1% Full Scale		
Diameter	3 inches (78 mm)		
Temperature Ranges	Operating/Medium 14°-39° 2' F/-10°-200° C Storage 14° -122° F/-10°-50° C Ambient 14°-167° F/-10°-75° C		
Pressure Ranges	Negative (Vacuum) and Positive through 0-15000 PSI		
Burst Pressure	30% Full Scale		
Engineering Units	Vacuum bar, "Hg, cmHg, mmHg Positive bar, psi, kg/cm², MPa, kPa		
LCD Display	5 1/2 Digits LCD, Blue Backlit-0.5 inches high		
Connection	Standard 1/4" PT		
Power Requirement	1. Input 100-120 VAC Adapter @ 60 Hz with output 5 VDC @ 1000 mA (included), or 2. Input 220-240 VAC Adapter @ 50 Hz with output 5 VDC @ 1000 mA (included), or 3. Input 5-24 VDC 2-wire wiring (1.5 meters)		Input 24 VDC 3-wire
Wetted Parts	Standard Brass or Optional Stainless Steel AISI 304/316		
Case Material	ABS Plastic with Black Lacquered		
High Pressure Capture	Standard		
Face Membrane	Tactile Feedback Raised Buttons		
Field Calibration	Zero Adjustment		
Output Signal	N/A	5 VDC, 3-9 wires wiring (1.5 meters) depending on numbers of Setting Points/Contacts purchased	1. Analog 4-20 mA, 3-wire, or 2. 0-5 VDC, 3-wire, or 3. 0-10 VDC, 3-wire
Functional Relay	N/A	1-8 Setting Points/Contacts depending on numbers of Setting Points/Contacts purchased Input 24 VDC required	N/A
Pressure Setting Points Contacts	N/A	1-4 Highs 1-4 Lows Standard 1 High or Low	N/A



Model DPS-75
Lower Mount with Flange



Model DPS-75
Lower Back Mount with Flange



Model DPG-75
Lower Mount

PRESSURE RANGES (PSI) / KG	MAXIMUM SAFE OVER PRESSURE (PSI) / KG See note (*) below for details.	INCREMENTAL DISPLAY STEPS (PSI) / KG
0-15 (15)/1	(19.5)/1.3	(.10)/0.006
0-30 (30)/2	(39.0)/2.6	(.20)/0.013
0-40 (40)/3	(52.0)/3.9	(.26)/0.02
0-60 (60)/4	(78.0)/5.2	(.40)/0.026
0-100 (100)/7	(130.0)/9.1	(.66)/0.046
0-140 (140)/10	(182.0)/13	(.93)/0.06
0-200 (200)/15	(260.0)/19.5	(1.30)/0.1
0-280 (280)/20	(364.0)/26	(1.86)/0.13
0-350 (350)/25	(455.0)/32.5	(2.33)/0.16
0-500 (500)/35	(650.0)/45.5	(3.33)/0.23
0-570 (570)/40	(741.0)/52	(3.80)/0.26
0-700 (700)/50	(910.0)/65	(4.66)/0.33
0-1,000 (1K)/70	(1,300.0)/91	(6.66)/0.46
0-1,400 (1.4K)/100	(1,820.0)/130	(9.33)/0.66
0-2,100 (2.1K)/150	(2,730.0)/195	(14.00)/1
0-2,800 (2.8K)/200	(3,640.0)/260	(18.66)/1.33
0-3,500 (3.5K)/250	(4,550.0)/325	(23.33)/1.66
0-4,200 (4.2K)/300	(5,460.0)/390	(28.00)/2
0-5,000 (5K)/350	(6,500.0)/455	(33.33)/2.33
0-5,700 (5.7K)/400	(7,410.0)/520	(38.00)/2.66
0-7,000 (7K)/500	(9,100.0)/650	(46.66)/3.33
0-8,500 (8.5K)/600	(11,050.0)/780	(56.66)/4
0-10,000 (10K)/700	(13,000.0)/910	(66.66)/4.66
0-15,000 (15K)/1000	(19,500.0)/1300	(94.66)/6.66

* Maximum Safe Over Pressure is the pressure which the unit can experience occasionally without loss of accuracy of permanent damage.

DIMENSIONS

DPG/DPS/PT-75 Lower Mount with Flange

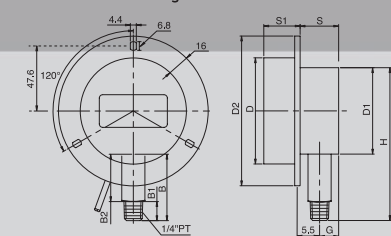

DPG/DPS/PT-75 Lower Back Mount with Flange

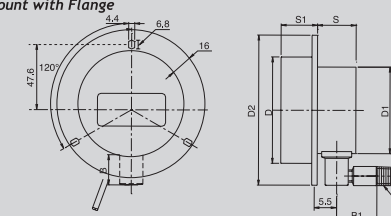

DPG/DPS/PT-75 Lower Mount

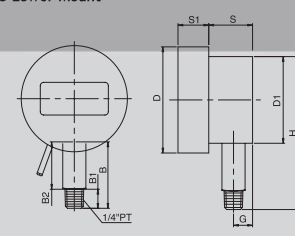

DPG/DPS/PT-75 Lower Back Mount

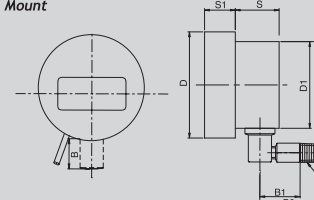

Model	D	D1	D2	B	B1	B2	S	S1	S2	S3	R	G	H
DPG/DPS/PT-75 Lower Mount with Flange	78	63.5	110	49	14	35	28.3	26.7				14	112.3
DPG/DPS/PT-75 Lower Mount	78	63.7		49	14	35	32.2	22.6				14	112.4
DPG/DPS/PT-75 Lower Back Mount with Flange	78	63.5	110	22	29.5	42	28.3	26.7				14	112.3
DPG/DPS/PT-75 Lower Back Mount	78	63.5		22	29.5	42	32.2	22.6				14	112.4